

Timing Belt Installation

Install the timing belt in the reverse order of removal.
Only key points are described there.

NOTE: Clean the middle cover and lower cover before installation.

1. Position the crankshaft and the camshaft pulleys as shown before installing the timing belt.

A. Set the crankshaft so that the No. 1 piston is at top dead center (TDC). Align the groove on the teeth side of the timing belt drive pulley to the V pointer on the oil pump.

B. Align the TDC marks on intake and exhaust pulleys.

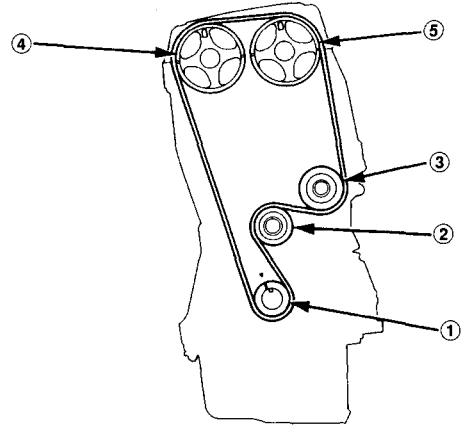

2. Install the timing belt tightly in the sequence shown.

① Timing belt drive pulley (crankshaft) → ② Adjusting pulley → ③ Water pump pulley → ④ Exhaust camshaft pulley → ⑤ Intake camshaft pulley.

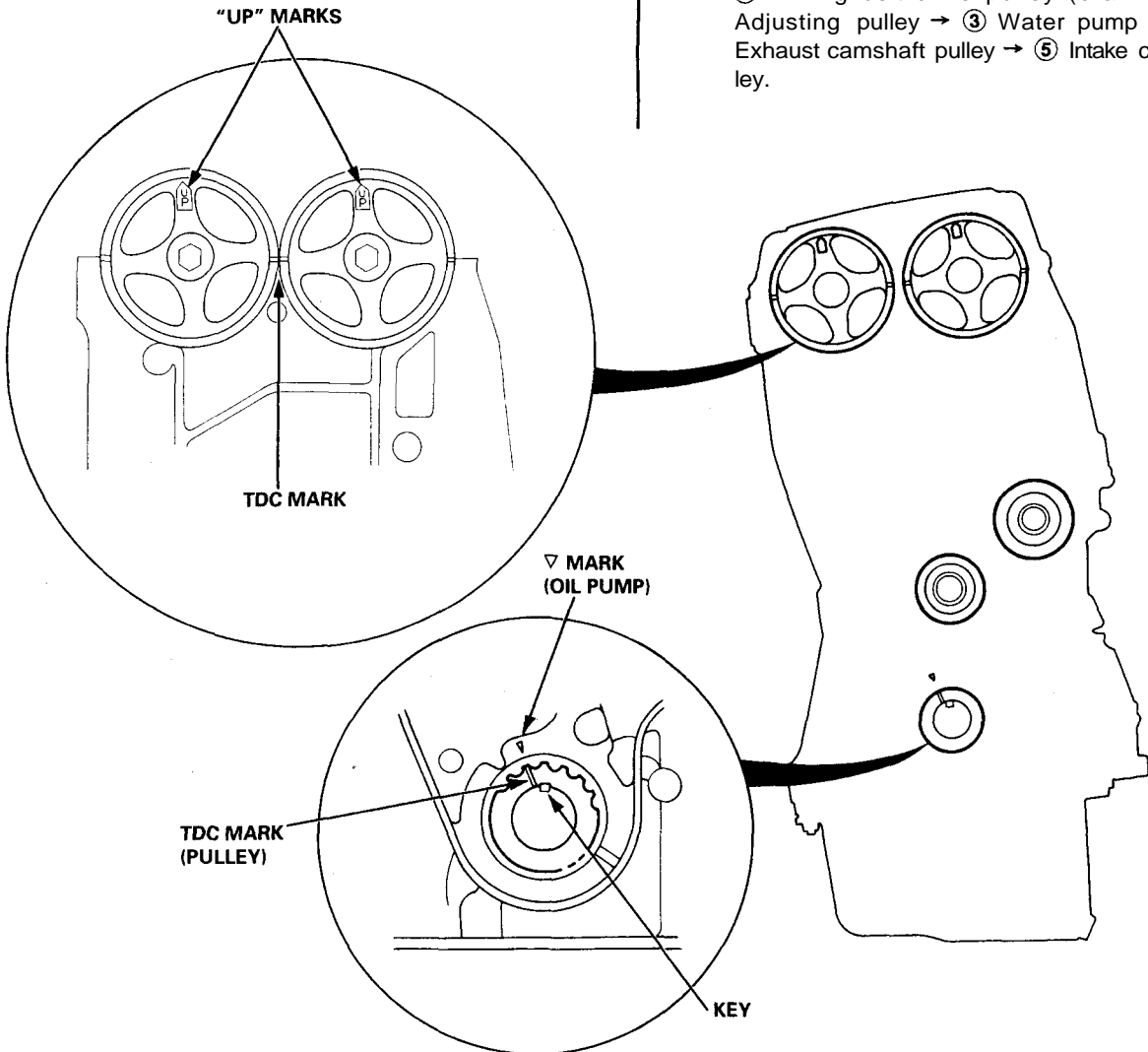



3. Loosen and retighten the adjusting bolt to tension the belt.
4. Rotate the crankshaft about 4 to 6 turns counter-clockwise so that the belt positions on the pulleys.
5. Adjust the timing belt tension (see page 6-47).
6. Check the crankshaft pulley and the camshaft pulleys at TDC.

CRANKSHAFT PULLEY:

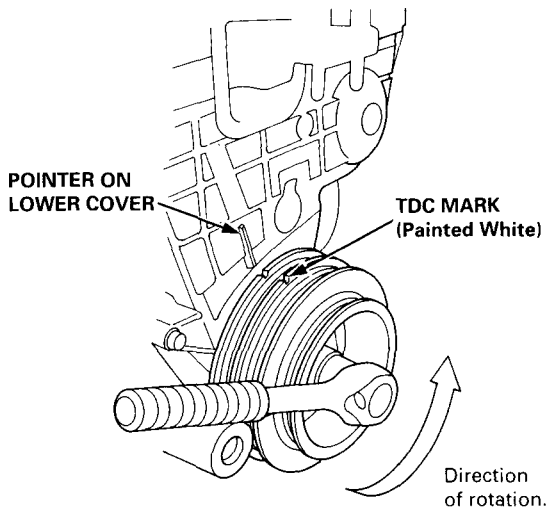

CAMSHAFT PULLEY:

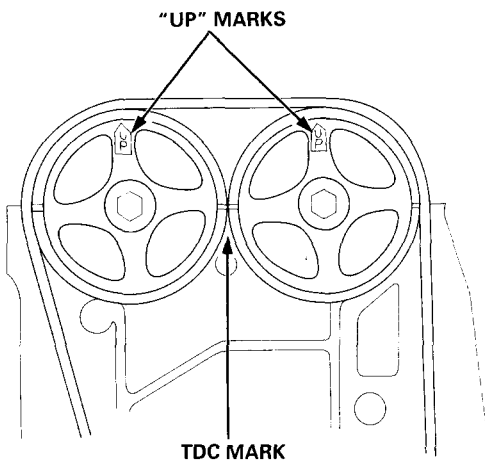

7. If a camshaft pulley is not positioned at TDC, remove the timing belt and adjust the positioning following the procedure on page 6-50, then reinstall the timing belt.

NOTE: Refer to page 6-48 for timing belt removal.

After installation, adjust the tension of each belt.

- See section 23 for alternator belt tension adjustment.
- See section 22 for A/C compressor belt tension adjustment.
- See section 17 for P/S pump belt tension adjustment.